

King Egbert School Year 9 Options Evening

Welcome to King Egbert School. This evening is about preparing to make some choices that will affect your studies throughout Year 10 and Year 11.

Main presentation [Hall]

- Crucible House and Henderson House 5.00pm
- Kelham House and Steel House 5.45pm

We expect the presentation to last approximately 20-25 minutes.

The presentation can be accessed after the event at any time by scanning the following QR code:

Individual subject sessions [B floor classrooms]

There will be short sessions through the evening where you can find out more about individual subjects.

These are shown on the next page, along with links to the relevant course specifications.

All sessions are on B floor (the floor the Hall is on). A map is on the back of this handout.

The following staff are also available throughout the evening:

- Ms Liddell (SENCO) and Mrs Hughes (Deputy SENCO) – Library
- Members of the Senior Leadership Team

A bell will ring at 7.00pm to mark the close of the evening.

5.00	Presentation in the Hall Crucible, Henderson	All Technology options History IT + Computer Science Languages PE (BTEC & GCSE)	B19 Performance area B21 B12 B23 B24
5.15		Science Geography Art Business Studies Drama Health & Social Care Music	B13 B25 B18 B22 B20 Drama Studio B16 B26
5.30		All Technology options History Business Studies Health & Social Care PE (BTEC & GCSE)	B19 Performance area B21 B22 B16 B24
5.45	Presentation in the Hall Kelham, Steel	Science Geography Languages IT + Computer Science Art Drama	B13 B25 B23 B12 B18 B20 Drama Studio
6.00		All Technology options History Business Studies PE (BTEC & GCSE) Music	B19 Performance area B21 B22 B24 B26
6.15		Science Geography Languages IT + Computer Science Art Drama Health & Social Care	B13 B25 B23 B12 B18 B20 Drama Studio B16
6.30		All Technology options History Music Languages PE (BTEC & GCSE) IT + Computer Science	B19 Performance area B21 B26 B23 B24 B12
6.45		Science Geography Business Studies Health & Social Care Art Music Drama	B13 B25 B22 B16 B18 B26 B20 Drama Studio

Subjects and Courses

Subject	Room	Exam Board, Course Code	Link
English: English Language GCSE English Literature GCSE	*	AQA, 8700 AQA, 8702	http://tinyurl.com/45fefduv http://tinyurl.com/yyxp3jzz
Mathematics 9-1 GCSE	*	Edexcel, 1MA1	http://tinyurl.com/wzffra7h
Science: Combined Science GCSE Biology GCSE Chemistry GCSE Physics GCSE	B13	Edexcel, 1SCO Edexcel, 1BIO Edexcel, 1CHO Edexcel, 1PHO	http://tinyurl.com/bde8kcem http://tinyurl.com/3vzw7j26 http://tinyurl.com/8fhrn95t http://tinyurl.com/583vk542
Art & Design GCSE	B18	AQA, 8201	http://tinyurl.com/ye2y2n4a
Business Studies GCSE	B22	Edexcel, 1BS0	http://tinyurl.com/mrxz477z
Computing: Computer Science GCSE Digital Information Technology BTEC	B12	OCR, J277 Edexcel, 60327406	http://tinyurl.com/5xs9wnxf http://tinyurl.com/3su2xnp4
Drama GCSE	B20	Edexcel, 1DR0	http://tinyurl.com/5528c2jf
DT: Design and Technology GCSE Construction and the Built Environment Level 1/2 Food Preparation and Nutrition GCSE Fashion & Textiles GCSE	B19	OCR, J310 WJEC, EduVQ8 AQA, 8585, AQA, 8204	http://tinyurl.com/4hsbj2de http://tinyurl.com/yck8y67c http://tinyurl.com/5yh8kxwf http://tinyurl.com/ye2y2n4a
Geography GCSE	B25	AQA, 8035	http://tinyurl.com/3n3adush
Health and Social Care BTEC Level 1/2 Tech Award	B16	Pearson, 60347076	http://tinyurl.com/4m8yaas6
History GCSE	B21	Edexcel, 1HI0	http://tinyurl.com/2rrwx3d
Languages: French GCSE German GCSE	B23	AQA, 8652 AQA, 8662	http://tinyurl.com/5ds3ytb9 http://tinyurl.com/54hjube
Music GCSE	B26	AQA, 8271	http://tinyurl.com/8xd4yyx9
PE: PE GCSE Sport BTEC	B24	AQA, 8582 Pearson, 60370683	http://tinyurl.com/48mubt3n http://tinyurl.com/2ejcsrb5

**Please note that English and Mathematics staff will not be present this evening as neither English nor Maths are optional for our students.*



School Map - B Floor

STAIRCASE 5

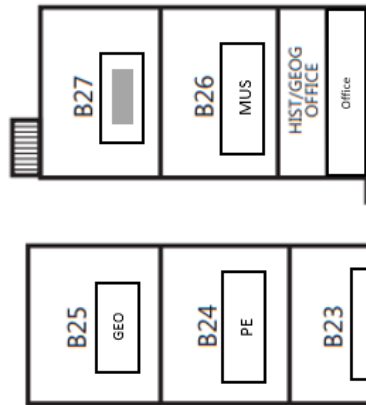

STAIRCASE 4

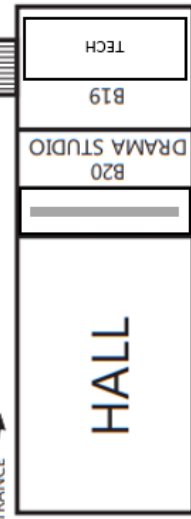
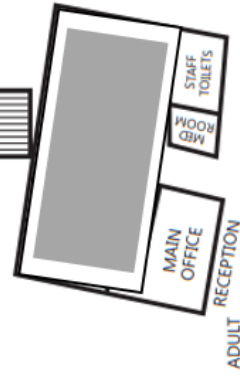

STAIRCASE 2

