

# **King Egbert School Year 9 Options Evening**

Welcome to King Egbert School. This evening is about preparing to make some choices that will affect your studies throughout Year 10 and Year 11.

## **Main presentation [Hall]**

- Crucible House and Henderson House 5.00pm
- Kelham House and Steel House 5.45pm

We expect the presentation to last approximately 20-25 minutes.

## **Individual subject sessions [B floor classrooms]**

There will be short sessions through the evening where you can find out more about individual subjects.

These are shown on the next page, along with links to the relevant course specifications.

All sessions are on B floor (the floor the Hall is on). A map is included inside this handout.

The following staff are also available throughout the evening:

- Ms Liddell (SENCO) and Mrs Hughes (Deputy SENCO) – Library
- Members of the Senior Leadership Team

*A bell will ring at 7.00pm to mark the close of the evening.*

*To access this handout electronically, please go to our website by scanning the following QR code or visiting <https://www.ecgbert.sheffield.sch.uk/page/?title=Y9+Options&pid=278>*



5.00	<b>Presentation in the Hall Crucible, Henderson</b>	All Technology options History IT + Computer Science Languages PE (BTEC & GCSE)	B19 Performance area B21 B12 B23 B24
5.15		Science Geography Art Business Studies Drama Health & Social Care Music	B13 B25 B18 B22 B20 Drama Studio B16 B26
5.30		All Technology options History Business Studies Health & Social Care PE (BTEC & GCSE)	B19 Performance area B21 B22 B16 B24
5.45	<b>Presentation in the Hall Kelham, Steel</b>	Science Geography Languages IT + Computer Science Art Drama	B13 B25 B23 B12 B18 B20 Drama Studio
6.00		All Technology options History Business Studies PE (BTEC & GCSE) Music	B19 Performance area B21 B22 B24 B26
6.15		Science Geography Languages IT + Computer Science Art Drama Health & Social Care	B13 B25 B23 B12 B18 B20 Drama Studio B16
6.30		All Technology options History Music Languages PE (BTEC & GCSE) IT + Computer Science	B19 Performance area B21 B26 B23 B24 B12
6.45		Science Geography Business Studies Health & Social Care Art Music Drama	B13 B25 B22 B16 B18 B26 B20 Drama Studio

## Subjects and Courses

Subject	Room	Exam Board, Course Code	Link
<b>English:</b> English Language GCSE English Literature GCSE	*	AQA, 8700 AQA, 8702	<a href="http://tinyurl.com/45fefduv">http://tinyurl.com/45fefduv</a> <a href="http://tinyurl.com/yyxp3jzz">http://tinyurl.com/yyxp3jzz</a>
<b>Mathematics</b> 9-1 GCSE	*	Edexcel, 1MA1	<a href="http://tinyurl.com/wzffra7h">http://tinyurl.com/wzffra7h</a>
<b>Science:</b> Combined Science GCSE Biology GCSE Chemistry GCSE Physics GCSE	B13	Edexcel, 1SC0 Edexcel, 1BI0 Edexcel, 1CH0 Edexcel, 1PH0	<a href="http://tinyurl.com/bde8kcem">http://tinyurl.com/bde8kcem</a> <a href="http://tinyurl.com/3vzw7j26">http://tinyurl.com/3vzw7j26</a> <a href="http://tinyurl.com/8fhrn95t">http://tinyurl.com/8fhrn95t</a> <a href="http://tinyurl.com/583vk542">http://tinyurl.com/583vk542</a>
<b>Art &amp; Design</b> GCSE	B18	AQA, 8201	<a href="http://tinyurl.com/ye2y2n4a">http://tinyurl.com/ye2y2n4a</a>
<b>Business Studies</b> GCSE	B22	Edexcel, 1BS0	<a href="http://tinyurl.com/mrxz477z">http://tinyurl.com/mrxz477z</a>
<b>Computing:</b> Computer Science GCSE Digital Information Technology BTEC	B12	OCR, J277 Edexcel, 60327406	<a href="http://tinyurl.com/5xs9wnxf">http://tinyurl.com/5xs9wnxf</a> <a href="http://tinyurl.com/3su2xnp4">http://tinyurl.com/3su2xnp4</a>
<b>Drama</b> GCSE	B20	Edexcel, 1DR0	<a href="http://tinyurl.com/5528c2jf">http://tinyurl.com/5528c2jf</a>
<b>DT:</b> Design and Technology GCSE Construction and the Built Environment Level 1/2 Food Preparation and Nutrition GCSE Fashion & Textiles GCSE	B19	OCR, J310 WJEC, EduVQ8 AQA, 8585, AQA, 8204	<a href="http://tinyurl.com/4hsbj2de">http://tinyurl.com/4hsbj2de</a> <a href="http://tinyurl.com/yck8y67c">http://tinyurl.com/yck8y67c</a> <a href="http://tinyurl.com/5yh8kxwf">http://tinyurl.com/5yh8kxwf</a> <a href="http://tinyurl.com/ye2y2n4a">http://tinyurl.com/ye2y2n4a</a>
<b>Geography</b> GCSE	B25	AQA, 8035	<a href="http://tinyurl.com/3n3adush">http://tinyurl.com/3n3adush</a>
<b>Health and Social Care</b> BTEC Level 1/2 Tech Award	B16	Pearson, 60347076	<a href="http://tinyurl.com/4m8yaas6">http://tinyurl.com/4m8yaas6</a>
<b>History</b> GCSE	B21	Edexcel, 1HI0	<a href="http://tinyurl.com/2rrwx3d">http://tinyurl.com/2rrwx3d</a>
<b>Languages:</b> French GCSE German GCSE	B23	AQA, 8652 AQA, 8662	<a href="http://tinyurl.com/5ds3ytb9">http://tinyurl.com/5ds3ytb9</a> <a href="http://tinyurl.com/54hjubde">http://tinyurl.com/54hjubde</a>
<b>Music</b> GCSE	B26	AQA, 8271	<a href="http://tinyurl.com/8xd4yyx9">http://tinyurl.com/8xd4yyx9</a>
<b>PE:</b> PE GCSE Sport BTEC	B24	AQA, 8582 Pearson, 60370683	<a href="http://tinyurl.com/48mubt3n">http://tinyurl.com/48mubt3n</a> <a href="http://tinyurl.com/2eicsrb5">http://tinyurl.com/2eicsrb5</a>

*\*Please note that English and Mathematics staff will not be present this evening as neither English nor Maths are optional for our students.*

## Y9 Options Booklet

The full Y9 Options Booklet, with detailed information about courses, key staff and the different types of qualifications, can be found by scanning the QR code below. Alternatively, please see the Options page of our website.





## School Map - B Floor

STAIRCASE 5

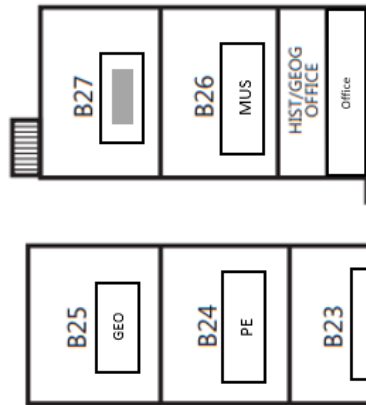

STAIRCASE 4

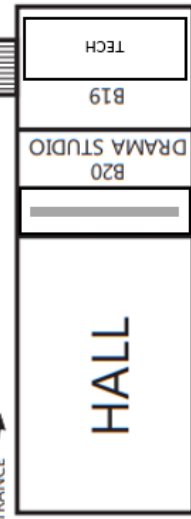
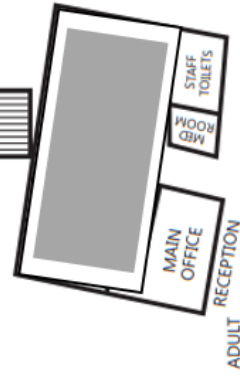

STAIRCASE 2

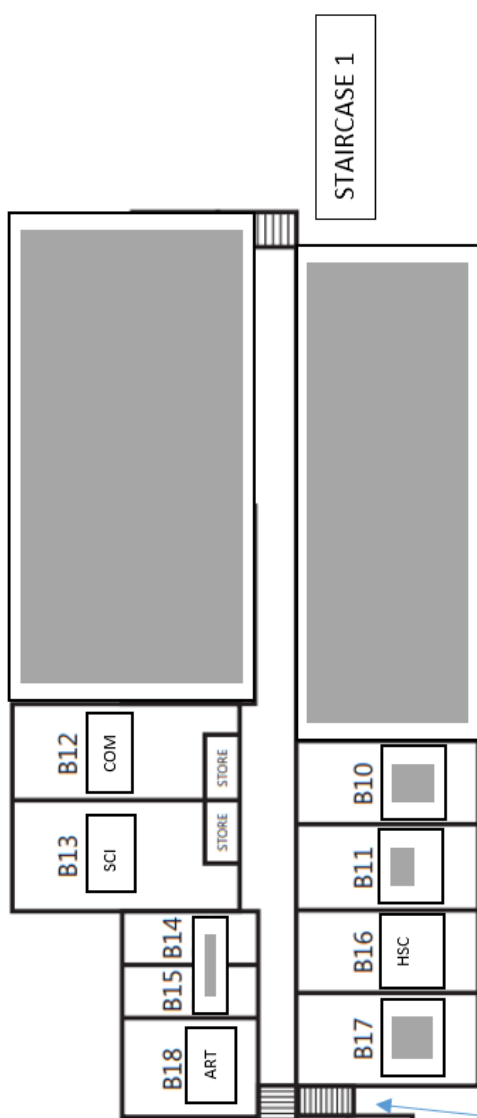

STAIRCASE 1